



SPÜLBOY®
ORIGINAL

INSTRUCTION MANUAL

CLASSIC LINE

SPÜLBOY® Neptun T 2000

SPÜLBOY® Twin Go T

SPÜLBOY® Twin Go T portable

Contents

1	Foreword	3
2	Unit Description & Purpose	3
3	Safety Instructions	3
4	Exploded View, Spare Parts & Accessories	4-7
5	Operation & Start-up	8
5.1	Set-up & Assembly	8
5.2	Start-up	8
6	Washing	9
6.1	Pre-washing	9
6.2	Rinsing & Post-rinsing	9
6.3	End of work & Shut-down	9
7	Cleaning, Care & Maintenance	10
8	Disposal & Recycling	11
9	SPÜLBOY Warranty	11

Dear SPÜLBOY® customer,

Thank you for your trust! We are delighted that you have chosen an Original SPÜLBOY quality product.

The globally established SPÜLBOY® brand is well acknowledged internationally for:



Engineering and production in accordance with DIN EN ISO 9001:2008



Best quality Made in Germany



Development and manufacturing in accordance with DIN 6653-3

All SPÜLBOY glass washers are portable and ensure the best washing results in all serving areas! Have fun with your new SPÜLBOY!
Your SPÜLBOY Team



Responsibility

Think new! Clean green!



Hygienic

Bacteria and virus-free washing results



Health

Protects people and the environment



Eco-Friendliness

Washing without electricity



Efficiency

Highly efficient water consumption



Made in Germany

Innovative & patented technology

1 Foreword

Please read the instruction manual before using your SPÜLBOY and keep it accessible for further use and for all users.

SPÜLBOY units may only be used by persons who are familiar with the safety instructions.

2 Unit description & purpose

Your SPÜLBOY consists of the following parts:

- 1 x unit with fixed pre-wash and rinsing canister or rinsing arms (depending on type of unit)
- 1 x bayonet middle brush with head, standard
- 1 x brush strip
- 1 x glass protection ring (or 2, depending on type of unit)
- 1 x inlet pipe with one-way valve
- 1 x double ring shower (Twin Go T, Twin Go T portable)
- 1 x connection hose, complete: easy-clix, 60cm hose, 3/8" connection thread
- drain hose for process water (Twin Go T portable)

This SPÜLBOY glass washer is used for the hygienic cleaning of serving receptacles in the catering sector, such as glasses, tankards and carafes.

3 Safety instructions!

- Continuously check the visual cleanliness of the SPÜLBOY.
- Check the connection hose and hose connections for damage, dirt or leaks



Do not clean the glass washer in a electrical dishwasher.

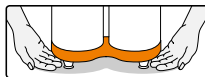

Always grasp firmly beneath the base when lifting the unit!

- The minimum pressure is 2 bar, the permissible maximum pressure is 6 bar (static)
- The glass washer must only be operated in its original condition and with original spare parts
- Stop the washing cycle immediately in case of broken glass!
Carefully remove all fragments of glass and clean the unit thoroughly with great care (item 7, page 10)
- Do not tip any food leftovers or other drink residues into the unit! This dirties the rinsing water and thus has a negative effect on the results of glass cleaning / rinsing.
- Turn off the tap at the close of business!

SPÜLBOY® & events

We recommend using a unit connection hose in accordance with DVGW W270 KTW A for portable use.

Please contact us incase of demand.

4.1 SPÜLBOY® Neptun T 2000

brush head, standard



brush head, large (optional)

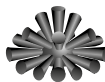

bayonet middle brush



glass protection ring



inlet pipe with one-way valve



brush strip

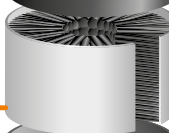

2-step spray control valve



suction foot with screw



fully equipped connection hose

3/8" connection



upper glass protection



soft-pads

angle connection easy-clip

Spare parts

Dimensions Neptun T 2000 H/B/T 330 mm/330 mm/190 mm
Dimension Canister Ø 180 mm

Internal glass height: middle brush with brush head, standard 235 mm
Internal glass height: middle brush with brush head, large 251 mm

	art. no.
brush strip	3890
middle brush with head, standard	3751
brush head, standard	3860
brush head, large	3861
inlet pipe with one-way valve	3956
2- step spray control valve	6046
glass protection ring	3930
upper glass protection	6060
connection hose easy-clix, 60 cm, 3/8" thread	5072
angle connection easy-clix	6075
suction foot with screw	5051
soft pads	6073

SPÜLBOY® cleaning & care products

SPÜLBOY glass washing tabs 2938

SPÜLBOY sanitizer powder 2910



4.2 SPÜLBOY® Twin Go T/ Twin Go T portable

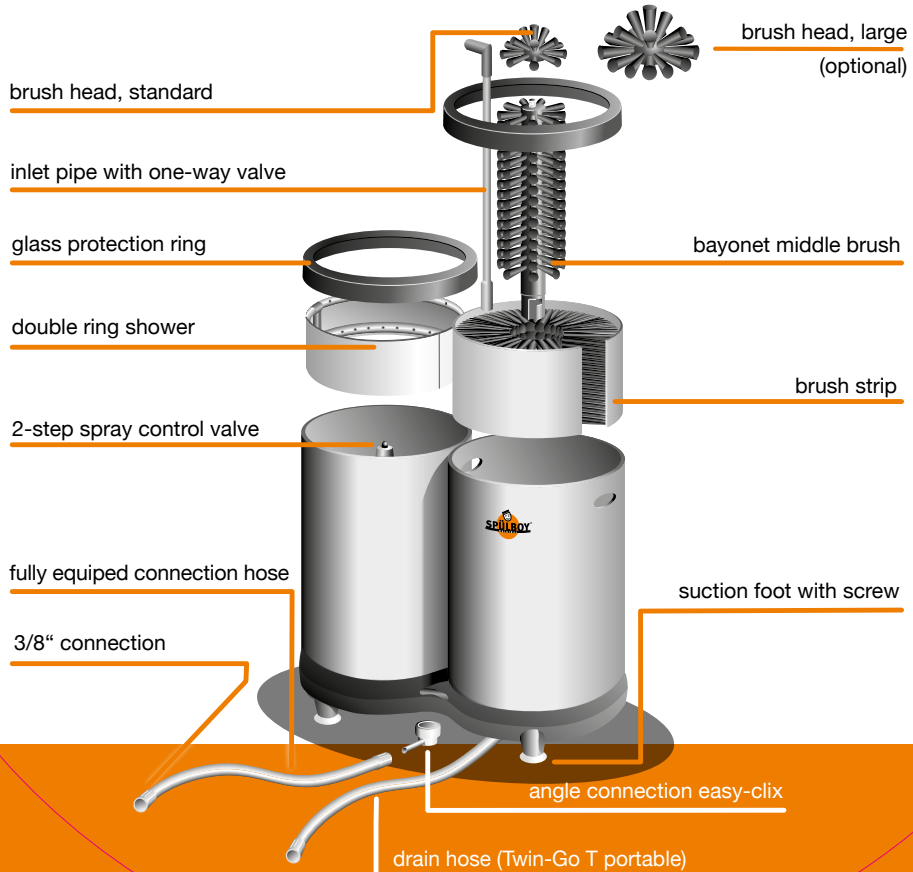

Spare parts

Dimensions Twin Go T/ Twin Go T portable H/B/T 375 mm /330 mm/190 mm
Dimension Canister Ø 180 mm

Internal glass height: middle brush with brush head, standard 235 mm

Internal glass height: middle brush with brush head, large 251 mm

	art. no.
brush strip	3890
middle brush with head, standard	3751
brush head, standard	3860
brush head, large	3861
inlet pipe with one-way valve	3952
2- step spray control valve	6046
double ring shower	4181
glass protection ring for pre-wash and rinsing canister	3930
upper glass protection	6060
connection hose easy-clix, 60 cm, 3/8" thread	5072
angle connection easy-clix	6075
suction foot with screw	5051
drain hose 60cm (Twin Go T portable)	5083

SPÜLBOY® cleaning & care products

SPÜLBOY glass washing tabs 2938

SPÜLBOY sanitizer powder 2910



5 Operation & Start-up

5.1 Set-up & assembly

- Install the SPÜLBOY in a counter sink with a suitable tap water connection and drain. Fasten the enclosed connection hose to the unit. (see below, Fig. 1-3)
- Please make sure that the sealing ring is lodged in the designated groove on the angle connection to avoid leaks.
- Set the safety slide to “OFF”, attach the connector to angle’s nozzle on the base of the SPÜLBOY and then engage the slide in the “ON” position, thus activating the lock.
- A “clix” signals a safe connection.
- Place the SPÜLBOY in the counter sink and fasten the open end of the water connection hose with a 3/8” wing to the under tap of the water fitting. Please also make sure that the seal fits correctly on the hose side.
- Check connections for leaks daily at start-up (and during operation)!

5.2 Start-up

- Before starting up your SPÜLBOY for the first time, after a prolonged period out of use or after repairs, please rinse the glass washer for approx. 5 seconds by actuating the rinsing function.
- Fill the pre-wash canister with cold tap water up to the top overflow and add one quarter (1/4) of a SPÜLBOY glass washing tablet in accordance with the dosing instructions.
- Adjust the water pressure at the rinse valve. The water pressure is set perfect when the water jets and rinsing function are horizontal.
- Your SPÜLBOY team will be happy to inform you about alternative connection options.

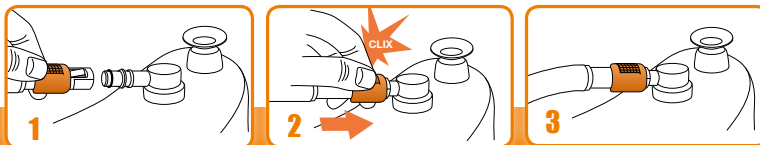

6 Washing

6.1 Pre-washing

- Check each receptacle/glass to be cleaned for any drink residues or other foreign bodies (e.g. lemon slices, straws) before starting the washing cycle and place them in a separate container.
- Hold the glass centrally in the canister over the middle brush and clean with at least four (4) full upward and downward movements (do not rotate).
- Light foaming of the rinsing water indicates that the SPÜLBOY glass washing tablet is working. If no foam appears, simply place another quarter (1/4) glass washing tablet in the pre-wash canister.
- 1/4 SPÜLBOY tablet ensures satisfactory cleaning performance for approx. 4-6 hours.

Please note:

The cleaning results may vary and the unit may be damaged if third-party substances are used.

6.2 Rinsing & Post-rinsing

- Place the glass on the telescopic rinsing unit and carefully rinse it from the inside and outside. Rinse with cold tap water for 3 seconds for the best results.
- The rinsing function also activates the fresh water supply in the pre-wash canister at the same time.
- The average water consumption per glass cleaning cycle is approx. 8 cl.

6.3 End of work & Shut-down

- Turn off the tap
- Disconnect the SPÜLBOY from the water supply
- Clean the unit and brushes (see item 7, page 10)
- Check components regularly for damage / wear

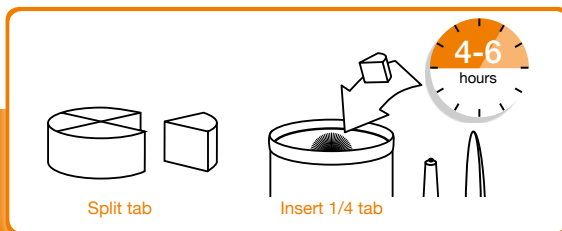

7 Cleaning, care & maintenance

- Make sure that you continuously check and keep the glass washer and the surrounding area clean, even when it is being used. The cleanliness of the unit, brushes and surrounding area should be checked at least once an hour.
- Clean the glass washer thoroughly at least once a day when used regularly. It should also be cleaned before starting up the unit for the first time, after a prolonged period out of use or after repairs.

Proceed as follows:

- First remove the glass protection ring and brush strip. Release the bayonet middle brush by a half turn to the left, remove from the pre-wash canister and drain the water. Grasp SPÜLBOY with both hands by the base and remove from the sink. Clean thoroughly with a suitable cloth and detergent. Clean the middle brush and brush strip with the original SPÜLBOY sanitizer powder. **1**
- To do this, place the brushes in a container, sprinkle 2 tablespoons of sanitizer powder over the brushes and add hot (50°C) water so that the brushes are completely covered. **2**
- Allow the sanitizer powder to take effect for 8-12 hours. **2**
- Rinse the brushes thoroughly with fresh water and reinsert into the pre-wash canister before using the unit again. **3**

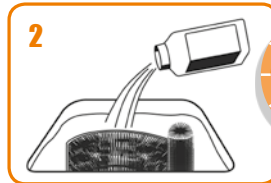

8-12
hours

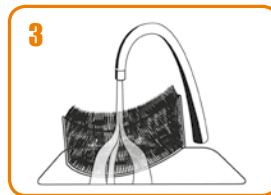

8 Sustainability & disposal

Perfect hygiene and cleanliness as well as environmental compatibility are not mutually exclusive at SPÜLBOY. All SPÜLBOY models work without electricity and with minimum and highly efficient water consumption per glass cleaning cycle.

Approx. 6 cl of water are required for each washing cycle and the water is only used when the rinsing function is actuated. The SPÜLBOY washing tablets are completely biodegradable. SPÜLBOY uses only high-quality and tested plastics.

The long service life is further enhanced by the modular product system – each component can be replaced as a spare part. All SPÜLBOY glass washers are fully recyclable and do not need to be disposed of as hazardous waste. SPÜLBOY is a member of Resy Organisation für Wertstoffentsorgung GmbH.

Please dispose of used products and plastic packaging in the designated plastic bins.



9 SPÜLBOY® Warranty

SPÜLBOY offers you a manufacturer's warranty of 2 years from the date of purchase. We will remedy all defects free of charge during this period, which are proven to be due to faulty material or workmanship and substantially impair its function. Other claims are excluded such as wear and tear on wearing parts (e.g. brushes or head valves).

The warranty does not cover damage resulting from failure to follow the operating instructions, improper handling or normal wear and tear.

The warranty becomes void in case of any kind of intervention not authorised by Schäfer Produkte GmbH. If a repair should be necessary, please send the SPÜLBOY without accessories, properly cleaned, well packed and with a description of the fault as well as proof of purchase, directly to Schäfer Produkte GmbH. The statutory warranty rights towards the seller and any possible seller warranties remain unaffected.

When sending in units, you must make sure that these have been hygienically cleaned and purged for labour law reasons.

Loss of warranty in the following cases:

- Improper handling
- Improper cleaning
- Inappropriate use
- Destruction of the unit by force
- Dismantling of a canister from the base
- Dismantling of one or both spray pipes (Neptun T 2000)
- Use of caustic and/or chlorinated active ingredients

Visit us at www.spuelboy.de



Schäfer Produkte GmbH

Simonshöfchen 53
42327 Wuppertal/ Germany

Tel: +49 (0) 202 695 32-0

E-Mail: info@spuelboy.de

www.spuelboy.de